



**Wireless Photoelectric Smoke Detector
HY-620**

Production Introduction

Wireless photoelectric smoke detector detects slow, smoldering fires through detecting smoke. when the smoke reach the alarm level, the detector will alarm by sound and light, and turn on the emergency light to remind you take appropriate measures to protect your life and property effectively.

Packing List

- Smoke alarm *1
- Mounting bracket *1
- screw *3
- certificate of quality*1
- double sides adhesive tape*1
- Manual *1
- Anchor plug*3

Product Profile

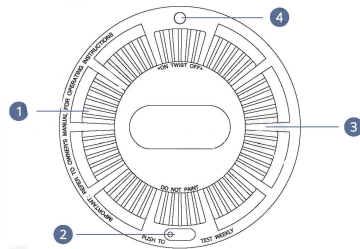

- 1 Smoke enter
- 2 Mute/self-check buttons and indicator lights
- 3 Emergency Light
- 4 Buzzer

Technical Parameters

- Battery Voltage: DC3V
(1 pieces CR17450 lithium battery, standby time 10 years, non-removable)
- Static current: $\leq 10\mu A$
- Alarm current: $\leq 100mA$
- Alarm sound: 85dB (3M)
- Radio Frequency: 433.92MHz

- Operating temperature: $0^{\circ}C \sim +50^{\circ}C$ / Humidity $\leq 95\%$ (RH)
- Execution standard: EN 14604:2005
- Weight: About 196g
- Dimension: 125mm*50mm (include mounting bracket)

Installation

1. Condition

For general places, when the space height is below 6m, the protection area is 60m², it should be install on the ceiling.

2. Installation Position

Alarm installation should follow the following principles: Install on suitable position to make sure People on sleeping can hear when alarm.

It is suggest that installing smoke detector horizontal on the ceiling, if it has to be installed on pitched ceiling, the angle of inclination should less than 45°.

Under horizontal ceiling: detector should be installed on center ceiling, which cannot have any shelter within 50CM. if detector cannot be installed on center ceiling, then the horizontal distance between wall, beam edge and detector should not less than 10CM.

After installation at the selected position, to test the detector can work fine with alarm panel, you can use the key needle to press the enroll button, if alarm panel has sound, then the detector can work with alarm panel.

Pitched ceiling: the distance between detector and highest point of the ceiling should not less than 50CM.

When an smoke detector is installed on the ceiling of an inner corridor which width less than 3M, it would be better to install on center. The installation distance of the detector should not exceed 10M. The distance between smoke detector and side wall should not bigger than half of the installation distance of the detectors.

Locations to Avoid:

- Places with obstructions;
- Places with high speed wind ($> 5 m/s$);
- In dusty, dirty or insect-infested area;
- In place near the stove which is easy to be polluted or high temperature place;
- When wall or ceiling is pitched, the distance between installation position and highest point of wall or ceiling should more than 50CM.

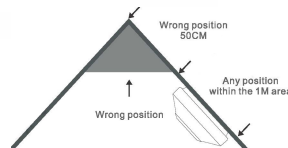
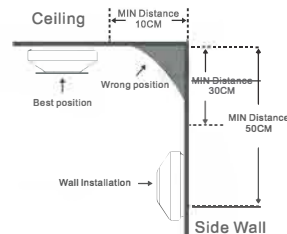

3. How To Install

- choose the suitable place.
- mark the chosen position of the three mount bracket screw, and drill three holes at this position.
- insert the anchor plug and screw the mounting bracket to the chosen position.
- Align the trig label on the hook board and alarm, then attach the alarm to the mounting bracket and turn clockwise to lock into place, till you hear "click" sound, that means install finished, and alarm will get power automatically.

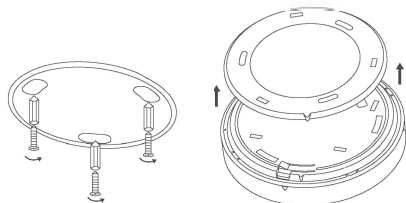

Fix the hanging plate with self-tapping screws.

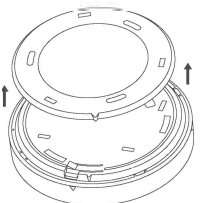

Align the alarm with the triangle mark on the on-hook board and close it.

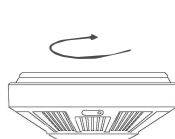

Turn it clockwise until you hear a "click".

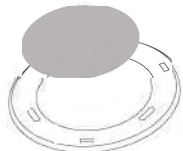

Schematic diagram of sticking double-sided tape.

Installation Notes

1. Standby

CONDITION	LED	HORN
Normal	Red LED flashes every 48seconds	
Low Battery	Yellow LED flashes every 48seconds	One beep every 48seconds
Fault	Yellow LED flashes every 48seconds	Three beeps every 48 seconds

2. Self-Checking Function

Press mute/self check button to make self checking.

CONDITION	LED	HORN
Normal	Red, Green, Yellow light flash 1time alternately	One beep
Low Battery	Yellow light flashes 1 time	One beep
Fault	Yellow light flashes 3 times	Three beeps

3. Analog alarm function

Press "mute/self-checking button"3S, the LED will turn to RED color and flash, Horn will sound, and emergency turn on, smoke detector enter Analog alarm status.

- ★ It is suggest that making self-checking and Analog alarm test every month to make sure that can find fault and maintenance in time.

- ★ When battery is low, analog alarm function is disable.

4. Alarm and Mute Function

When detector in normal status, he red light will flash every 48seconds. when the smoke reach the alarm level, the detector will alarm, LED light flash fast, and emergency light turn on.

If make sure it is not fire, can press "mute/self-checking button"to stop the alarm.

- ★ Fire alarm is silence after press MUTE button and will continue about 5min, during this time, there is not light and sound alarm. After 5min, the smoke detector will resume normal monitoring.

5. False Alarm

When detector detects the smoke sensor fault, the LED yellow light will flashes every 48s and flashes 3 times, also has 3 beeps, then please ask maintenance person to test and repair it as soon as possible.

When Fault alarm, long press mute/self-checking button 3seconds to let the detector in silence about 12 hours. when detector in silence status, press mute/self-checking button, the detector will resume normal work.

6. Low Battery Function

When detector detects low battery, the yellow light will flash 1 time every 48s, and has 1 beep.

When low battery alarm, long press "mute/self-checking button"3 seconds to let the detector in silence about 12 hours. when detector in silence status, press mute/self-checking button, the detector will restore the alarm beeping. When low battery alarm, please replace it with a new detector in time.

Warning

- ★ The alarm self-test function only provides infrared photoelectric sensor fault detection and low battery detection. The sensitivity of the sensor still needs to be tested as required.

- ★ In order to ensure the smoke sensitivity of the product, the surface of the alarm should be cleaned with a soft brush every 6 months, and the power must be disconnected before cleaning.

- ★ In the process of use, if the product is failure, please contact the supplier in time, and do not disassemble and repair it yourself to avoid accidents.

- ★ If it is not used for a long time, please separate the alarm from the hanging board to disconnect the power supply, put it in the packing box, and store it in a dry and ventilated place.

Photoelectric smoke alarms can reduce disasters, but they are not guaranteed to be foolproof. For your safety, please use this product correctly. At the same time, you should be vigilant in daily life and strengthen the awareness of safety and prevention.

Trouble shooting

PROBLEM	REASON	SOLUTION
Alarm immediately when connect power	Alarm instability	Press "mute/self-checking" button or re-connect power
	There is a lot of smoke or steam in the room	Remove dust and steam and connect power
	Internal circuit damage	Return to factory for repair
After alarm, there is no sound from horn or the volume are too low	The alarm has been in use for more than 10 years	Return to factory for repair
	Horn damage	
Press "mute/self-checking" button, no response	The mount bracket is not screwed into the alarm	Attached the mount bracket into the alarm